

HUSH
PROFESSIONAL

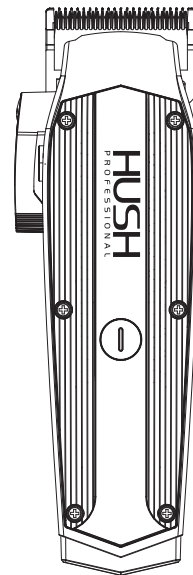

PATENTS:
2022 3055 0596.8
2020 3024 3743.8
2019 2150 4977.1
2021 2073 3916.3
2019 2171 4464.3

HU22C
PROFESSIONAL HAIR CLIPPER
MANUAL

Eagle Fortress International Limited



SAFETY PRECAUTIONS

This clipper has a built-in rechargeable lithium battery, please do not use in high temperature environment.

To avoid overheating, fire or explosion.

Use a power supply that matches the voltage rating indicated on the power adapter.

Insert the power adapter plug to the electric socket completely while charging.

Keep away from water or chemicals while in use.

To avoid shock or damage to the clipper.

Do not immerse the main engine in water or flush clipper with water.

Stop using the power adapter immediately & replace right away if the cord on the power adapter is damaged.

Unplug from power adapter not in use for a long time.

Plug or unplug power adapter should hold the insulating part instead of power cord.



WARNING

Keep away from children.

Do not store within the reach of children. Putting parts such as blades or lubricant containers of the clipper into mouth may cause accidental injury.

Do not plug or unplug the power adapter with wet hands.

To avoid the risk of electric shock and cause injury.

Unplug before cleaning the clipper.

Before cleaning and maintenance, please power off the clipper to avoid the short circuit and electric shock.

Only use the original accessories and power adapter manufactured by HUSH.

Avoiding the occurrence of fire due to overheating of the charging circuit due to different specifications of the power adapter.

Do not disassemble or repair the clipper on your own.

Check carefully the blade for damage or deformation before use.

To avoid the skin injury.

Extended use in temperature below -10°C or above 40°C is not recommended as it may damage the battery.

Stop using the clipper immediately when:

The machine or power adapter is deformed or hot.

The machine or power adapter has a burning smell.

The machine or power adapter occurs abnormal noise within use.

Please return the clipper to the distributor or manufacturer for service.

PRODUCT OVERVIEW

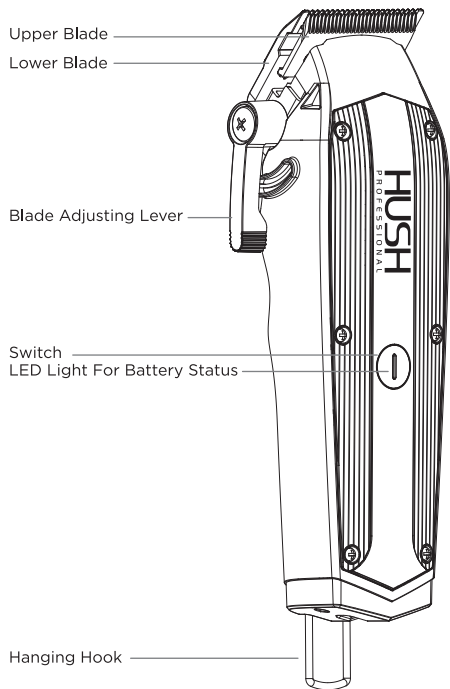

Brush



Lubricant

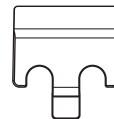

Blade Protector

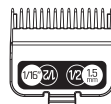

1/2# Comb
1/16" (1.5mm)

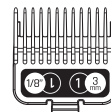

1# Comb
1/8" (3mm)

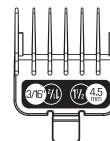

1/2# Comb
3/16" (4.5mm)

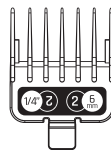

2# Comb
1/4" (6mm)

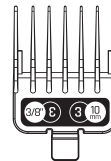

3# Comb
3/8" (10mm)

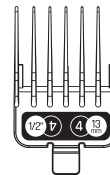

4# Comb
1/2" (13mm)

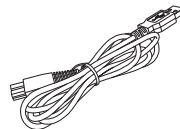

Power Cord

CHARGING OPERATION



1. Connect the USB charging cable with clipper to charge.
2. Charging time: 3 hours
3. Using time: 3 hours

LED indicator status when charging

When the clipper is not fully charged, red light will continue to flash. When the clipper is fully charged, red light will stop flashing and the white light will remain on.

LED indicator status when in use

When the clipper battery is high, the white light will remain on. When the clipper battery is low, the red light will flash. Clipper will shut down and the red light will turn off when the battery is dead.

Adjusting the cutting length

The clipper comes with 5 different adjustment levels, which are 0.8mm, 1.4mm, 2.0mm, 2.8mm and 3.5mm. Users can adjust the level according to their needs.

As the shown for the following figure.

Push the blade adjustment lever forward for a closer cut.

Push the blade back for the reverse effect.

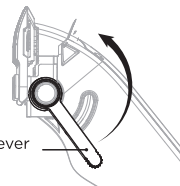

Blade Adjustment Lever

How to install and replace guards

Before replacing guard, make sure the clipper is turned off.

Clipper comes with 10 guards.

Sizes are: 1/2#(1.5mm), 1#(3mm), 1 1/2#(4.5mm), 2#(6mm), 3#(10mm), 4#(13mm).

Installing your guard:

As shown on the right, align the card slot corresponding to the guard with the main unit of the product, and then lift the main unit gently until you hear a 'click', which indicates that the installation of the guard is complete.

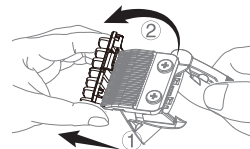

Removing your guard:

As shown on the right, you can remove the guard by turning the tail of the comb with your finger.

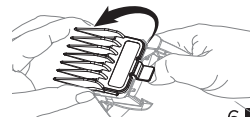



When handling the blade, do not try to sharpen or alter the blade by yourself to avoid damaging your machine.

Please read the blade maintenance instructions carefully before operating. Following the instructions when removing and installing the blade to avoid improper assembly.

After the blade is installed, be sure to carefully check whether the corresponding parts have been firmly attached.

Blade installation

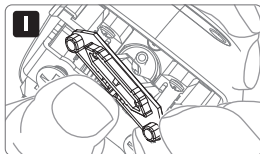

Install the movable blade on the two pins of the spring leakage.

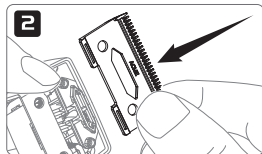

Put the upper blade on the movable blade smoothly (no looseness).

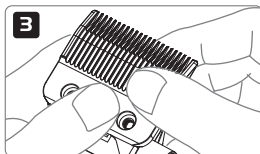

The lower blade is pressed down smoothly and aligned with the bottom screw hole.

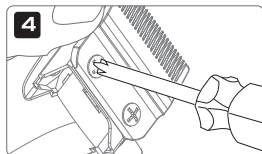

Insert the screw clockwise into the 2/3 depth.

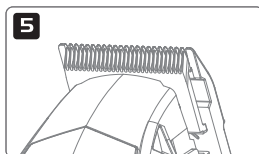

Insert the blade adjustment tool. Check the upper and lower blades are in the center and parallel area.

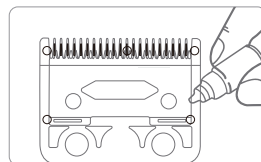

After the cutter head is installed, drip 1-2 drops of lubricant on the corresponding five areas.

Blade removal

Hold the clipper as shown in figure 1 on the right, loosen the screws, and remove the blade. When removing the blade, please hold the blade while holding the clipper to prevent the blade from falling and being damaged (the blade is sharp. Pay attention to protect your hands).

As shown in figure 2, remove the upper blade and the movable blade holder together.

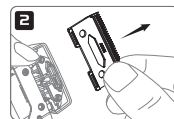
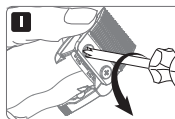

Blade cleaning and maintenance

As shown in figure 3. Use a brush to clean the main body, the hair debris in the upper and lower blades.

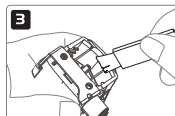

WARRANTY

1. Under normal conditions of proper use and maintenance of the product, the warranty period of the product is 1 year.
2. Expendable parts, such as blades, guards, lubricants, cleaning brushes, etc., are not under the terms of the warranty.
3. The following conditions are not covered by the warranty service:
 - Failure to show a valid warranty card, or the information on the warranty card is inconsistent with the actual product.
 - Clippers with alterations will not be covered by the warranty service.
 - Proof of purchase must be included with warranty card.
 - Failure to follow the instructions in the instruction manual to operate and maintain the clipper, causing it to malfunction or damage it by dropping the clipper, immersing the clipper in water and physical alterations of any kind will void the warranty service.
 - Product damage due to transportation or improper storage.
4. This warranty card is the only warranty certificate, please store it properly along with your proof of purchase.
5. The company will charge a maintenance fee for products without a warranty card or beyond the warranty period.
6. Please send the clipper in need of repair or warranty directly to the designated HUSH domestic service center for repair, maintenance, or replacement.

WARRANTY CARD

Seller contact information	
Seller	
Address	
Tel	
Please fill in this warranty card on the spot immediately after purchase.	
Customer contact information	
Client name	
Contact phone	
Date produced	
Address	
Date purchased	